

Sunday 1 March 2026
NEWSLETTER

Haere mai - Welcome!

If you're new to Legacy, we pray you feel welcomed and refreshed. Please ask one of our host team if there's anything you would like to know or get help in.

Our service begins and ends with a hot drink as part of our 'welcome' and providing time to connect. Please do stay on so we can get to know you!

Speaking today: **Ps Nigel Ripley**

Legacy

Community
Church

*A community of worshipping disciples;
overflowing with God's love and presence;
serving and transforming lives, communities
and generations with the gospel of Jesus Christ.*

Pre Service Prayer 9.30am in North Room 1

Children's Programmes

Under 5's - Connect Lounge

Yr 0-5 'Oasis'- Nicholas Room, Yr 6-8 'Elevate' - begin in the Nicholas Room.

Start times will be announced during the service

NOTE: For health & safety reasons, visitors with children are asked to fill out a Children's programme 'Visitor's Form' and leave it with a leader in the programme. Thanks!

This Week

LiVE Community

Tuesday, Wednesday, Thursday 10am-12:30pm in the Nicholas Room!

Dance Workz

This Tuesday and Wednesday at 11am here in the gym, \$3 per person.

Pre-Work Prayer

This Friday 8am in the Tōtara Room.

SWAT Playgroup

Fridays 10:30am-12pm. See Ps Mana for details.

Legacy Youth Centre

This Friday 7-9pm here at Legacy for high school aged youth.



Legacy Community Night TONIGHT! 5pm—8pm

Join us for our first Community Night for 2026; a night of fellowship, food and fun from 5pm to 8pm. Bring friends, dinner and games!

Easter Camp 2026 2—7 April, Spencer Park

If you would like to support the team, we're in need of donations for registrations, tents, and volunteers, especially for pack down. Please also continue to pray for the team. See Jacinta for more info'



PASTOR JONAH NZ VISIT



Would you like to sponsor Pastor Jonah and Sylvia's visit to NZ this year?

We are wanting to raise funds for them to visit us from Uganda and minister to other churches here. Return flights will be around \$6000-\$8000. If you would like to help them get here, please contact Ps. Nigel.



Hope Project Deliveries

Would you be willing to give some time to delivering 'Hope' booklets in letter boxes as you prayer walk some streets in the community? Email office@legacycommunity.nz



Our service messages can be viewed on our YouTube channel

Giving References:

Legacy Building Fund - **'LBF'**

Vision & Grace Funds (for charity and mission) - **'VG'**

Uganda School & Church - **'VGU'**

'Tithes': Provides for the week to week running of the church and all we do.

Giving envelopes are by the 'Donations' box at the back on the info' table.

Remember to use your giving # if you would like a receipt for giving.

If you don't have a giving # contact the office and they will assign you one.

Further details re' online giving are in the giving envelope.

ACCOUNT NUMBER: **031700 0005835 000**

Receipts will be issued in April each year.

For more info, email: finance@legacycommunity.nz, or phone our office: 3834895

Finances



Audio versions of our Service Messages are available online via [legacycommunity.nz/resources](https://www.legacycommunity.nz/resources) or see our YouTube channel for older service videos.

www.legacycommunity.nz

Facility Map

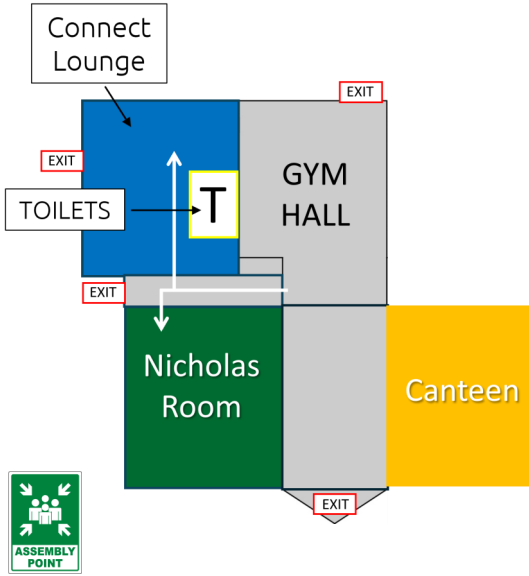

www.legacycommunity.nz

Contact Us

Church Office

Ph. 3834895. 52 Bassett St.

Christchurch 8083

Email: office@legacycommunity.nz

Or: finance@legacycommunity.nz

Specific Enquiries

Lead Pastors: **Nigel & Mana Ripley**

Nigel: n.ripley@legacycommunity.nz

p: 027 2293184

Mana: mana.r@legacycommunity.nz

p: 027 3399322

Junior Church Pastor: **Amber Tucker**

e: amber.t@legacycommunity.nz

p: 027 4211421

Lead Youth Worker: **Jacinta Gomez**

e: jacinta.g@legacycommunity.nz

p: 0273348398

Community Worker: **Lara Cook**

e: community.worker@legacycommunity.nz

p: 0274938053

[Note: Staff are unavailable on Mondays as this is their day off]

Note Taking

3 things I need to do or give attention to:
