

Sunday 1 February 2026

NEWSLETTER

Haere mai - Welcome!

If you're new to Legacy, we pray you feel welcomed and refreshed. Please ask one of our host team if there's anything you would like to know or get help in.

Our service begins and ends with a hot drink as part of our 'welcome' and providing time to connect. Please do stay on so we can get to know you!

Speaking today: **Ps Botros Morgan**

Legacy

**Community
Church**

*A community of worshipping disciples;
overflowing with God's love and presence;
serving and transforming lives, communities
and generations with the gospel of Jesus Christ.*

Pre Service Prayer 9.30am in North Room 1

Children's Programmes

Under 5's - Connect Lounge

Yr 0-5 'Oasis'- Nicholas Room, Yr 6-8 'Elevate' - begin in the Nicholas Room.

Start times will be announced during the service

NOTE: For health & safety reasons, visitors with children are asked to fill out a Children's programme 'Visitor's Form' and leave it with a leader in the programme. Thanks!

This Week

Social Volleyball

Mondays 7 - 9pm, here in the gym; high powered but friendly.

Live Community

Tuesday, Wednesday, Thursday 10am-12:30pm in the Nicholas Room!

Dance Workz

This Tuesday and Wednesday at 11am here in the gym, \$3 per person.

Pre-Work Prayer

This Friday 8am in the Tōtara Room.

SWAT Playgroup

SWAT Playgroup is returning this year from Fri' 13 Feb' 2026. See Ps Mana for info'

Legacy Youth Centre

No Youth Centre this week as we'll be joining the church picnic during the day.

A poster for the Waitangi Picnic. The background is a photograph of a group of young people sitting on a grassy area with trees in the background. Overlaid on the photo is the text 'WAITANGI PICNIC' in large white letters. Below that, in a white box, is 'FRIDAY 6 FEBRUARY 11AM', 'Spencer Park', and 'BYO Picnic Food. Bring Friends'. In the bottom right corner is a red circular logo with a picnic basket icon and the word 'PICNIC'. At the bottom of the poster is a grey bar with the text 'Check on facebook if weather is wet or cold'.



Our service messages can be viewed on our YouTube channel

Giving References:

Legacy Building Fund - 'LBF'

Vision & Grace Funds (for charity and mission) - 'VG'

Uganda School & Church - 'VGU'

'Tithes': Provides for the week to week running of the church and all we do.

Finances

Giving envelopes are by the 'Donations' box at the back on the info' table.

Remember to use your giving # if you would like a receipt for giving.

If you don't have a giving # contact the office and they will assign you one.

Further details re' online giving are in the giving envelope.

ACCOUNT NUMBER: **031700 0005835 000**

Receipts will be issued in April each year.

For more info, email: finance@legacycommunity.nz, or phone our office: 3834895



Audio versions of our Service Messages are available online via [legacycommunity.nz/resources](https://www.legacycommunity.nz/resources) or see our YouTube channel for older service videos.

www.legacycommunity.nz

Facility Map

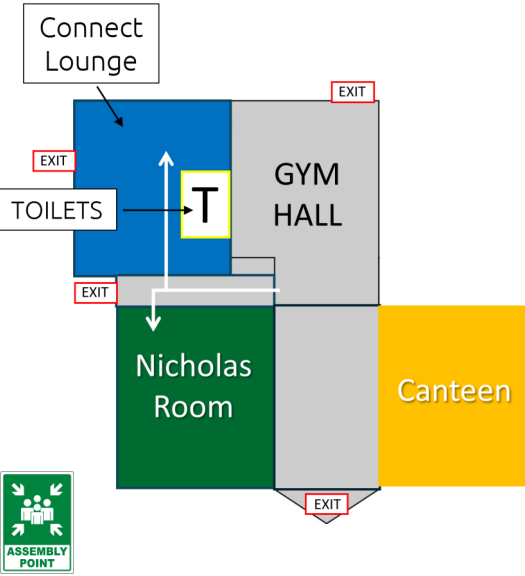

www.legacycommunity.nz

Contact Us

Church Office

Ph. 3834895. 52 Bassett St.

Christchurch 8083

Email: office@legacycommunity.nz

Or: finance@legacycommunity.nz

Specific Enquiries

Lead Pastors: **Nigel & Mana Ripley**

Nigel: n.ripley@legacycommunity.nz

p: 027 2293184

Mana: mana.r@legacycommunity.nz

p: 027 3399322

Junior Church Pastor: **Amber Tucker**

e: amber.t@legacycommunity.nz

p: 027 4211421

Lead Youth Worker: **Jacinta Gomez**

e: jacinta.g@legacycommunity.nz

p: 0273348398

Community Worker: **Lara Cook**

e: community.worker@legacycommunity.nz

p: 0274938053

[Note: Staff are unavailable on Mondays as this is their day off]

Note Taking

3 things I need to do or give attention to:
