

Sunday 24 May 2026
NEWSLETTER

Haere mai - Welcome!

If you're new to Legacy, we pray you feel welcomed and refreshed. Please ask one of our host team if there's anything you would like to know or get help in.

Our service begins and ends with a hot drink as part of our 'welcome' and providing time to connect. Please do stay on so we can get to know you!

Speaking today: **Ps Nigel Ripley**

Legacy

Community
Church

*A community of worshipping disciples;
overflowing with God's love and presence;
serving and transforming lives, communities
and generations with the gospel of Jesus Christ.*

Pre Service Prayer 9.30am in North Room 1

Children's Programmes

Under 5's - Connect Lounge

Yr 0-5 'Oasis'- Nicholas Room, Yr 6-8 'Elevate' - begin in the Nicolas Room.

Start times will be announced during the service

NOTE: For health & safety reasons, visitors with children are asked to fill out a Children's programme 'Visitor's Form' and leave it with a leader in the programme. Thanks!

This Week

LiVE Community

Tuesday, Wednesday, Thursday 10am-12:30pm in the Nicholas Room!

Dance Workz

This Tuesday and Wednesday at 11am here in the gym, \$3 per person.

Pre-Work Prayer

This Friday 8am in the Tōtara Room.

SWAT Playgroup

Fridays 10:30am-12pm. See Ps Mana for details.

Legacy Youth Centre

This Friday 7-9pm at Legacy, for high school aged youth.

FUSION

For school leavers to age 30, every second Saturday at Legacy from 6:30pm. Open this Saturday in the Canteen. Contact Josh or Zeph for



LEGACY COMMUNITY NIGHT Sun' 7 June 5-8PM

Join us for our next Community Night; a time of fellowship, food and fun from 5pm to 8pm. Bring friends, dinner and games!

TARGET: 100 TO 1



Over 2026 we want to raise between \$100,000 to pay down debt, and \$1 million to **complete** the whole facility development. Consider what you would be willing to donate to complete this legacy project and set up the next generation of worship and mission for our church. Grab a form from the foyer

Pledges/donations can be made using our main account below, and the reference 'LBF'.

Garden Clearing Help Wanted

We have 2 church properties that need gardens 'tamed' and rubbish cleared. If you would like to be a part of the team to help, please contact Ps Nigel.



Our service messages can be viewed on our YouTube channel

Giving References:

Legacy Building Fund - 'LBF'

Vision & Grace Funds (for charity and mission) - 'VG'

Uganda School & Church - 'VGU'

'Tithes': Provides for the week to week running of the church and all we do.

Giving envelopes are by the 'Donations' box at the back on the info' table.

Remember to use your giving # if you would like a receipt for giving.

If you don't have a giving # contact the office and they will assign you one.

Further details re' online giving are in the giving envelope.

ACCOUNT NUMBER: **031700 0005835 000**

Receipts will be issued in April each year.

For more info, email: finance@legacycommunity.nz, or phone our office: 3834895

Finances



Audio versions of our Service Messages are available online via legacycommunity.nz/resources or see our YouTube channel for older service videos.

www.legacycommunity.nz

Facility Map

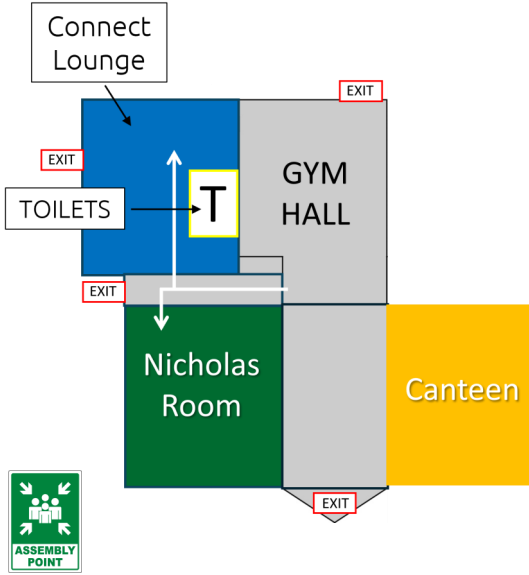

www.legacycommunity.nz

Contact Us

Church Office

Ph. 3834895. 52 Bassett St.

Christchurch 8083

Email: office@legacycommunity.nz

Or: finance@legacycommunity.nz

Specific Enquiries

Lead Pastors: **Nigel & Mana Ripley**

Nigel: n.ripley@legacycommunity.nz

p: 027 2293184

Mana: mana.r@legacycommunity.nz

p: 027 3399322

Junior Church Pastor: **Amber Tucker**

e: amber.t@legacycommunity.nz

p: 027 4211421

Lead Youth Worker: **Jacinta Gomez**

e: jacinta.g@legacycommunity.nz

p: 0273348398

Community Worker: **Lara Cook**

e: community.worker@legacycommunity.nz

p: 0274938053

[Note: Staff are unavailable on Mondays as this is their day off]

Note Taking

3 things I need to do or give attention to:
