

Sunday 5 April 2026
NEWSLETTER

Haere mai - Welcome!

If you're new to Legacy, we pray you feel welcomed and refreshed. Please ask one of our host team if there's anything you would like to know or get help in.

Our service begins and ends with a hot drink as part of our 'welcome' and providing time to connect. Please do stay on so we can get to know you!

Happy Easter!

Legacy

Community
Church

*A community of worshipping disciples;
overflowing with God's love and presence;
serving and transforming lives, communities
and generations with the gospel of Jesus Christ.*



Today

Pre Service Prayer 9.30am in North Room 1.

Our Children will be with us in the service for today. Children's supervision will resume next Sunday.

This Week

LiVE Community

Closed for the school holidays, returning Tue 21 April. However, there will be a café outing at Waimairi Golf Course Clubhouse on Tuesday 7 April, book with Lara.

Dance Workz - Closed for the school holidays, returning Tue 21 April.

Pre-Work Prayer

This Friday 8am in the Tötara Room.

No SWAT Playgroup

There will be no SWAT during the school holidays.

No Legacy Youth Centre

No Youth Centre this Friday - we'll be back Friday 17 Apr

Men's Breakfast

This Saturday 8:30am, \$10pp. Book with Keith by Wednesday: 0276299003

LOVING OUR LEGACY

How will you advance each of these areas this year, in building our church's legacy for the next generation?:

PRAYER FINANCE SERVICE FELLOWSHIP

UPCOMING OPPORTUNITIES

- **Bible Reading Group:** A group that explores the scriptures together to learn how to listen for the Holy Spirit speaking. This is not a study but a practice.
- **Baptism:** An important step in confirming your faith in Jesus and declaring publicly your commitment to Him.

If you would like to be involved or get more info', please contact Ps. Nigel.

Trust AGM

Next Sunday 12 April, 12.30pm. Come and hear how things are going with our church finances and property.



Pastor Jonah NZ visit

Would you like to help sponsor Pastor Jonah and Sylvania's visit from Uganda to NZ this year? If you would like to help them get here, please contact Ps. Nigel.



Our service messages can be viewed on our YouTube channel

Giving References:

Legacy Building Fund - 'LBF'

Vision & Grace Funds (for charity and mission) - 'VG'

Uganda School & Church - 'VGU'

'Tithes': Provides for the week to week running of the church and all we do.

Giving envelopes are by the 'Donations' box at the back on the info' table.

Remember to use your giving # if you would like a receipt for giving.

If you don't have a giving # contact the office and they will assign you one.

Further details re' online giving are in the giving envelope.

ACCOUNT NUMBER: **031700 0005835 000**

Receipts will be issued in April each year.

For more info, email: finance@legacycommunity.nz, or phone our office: 3834895

Finances



Audio versions of our Service Messages are available online via [legacycommunity.nz/resources](https://www.legacycommunity.nz/resources) or see our YouTube channel for older service videos.

Facility Map

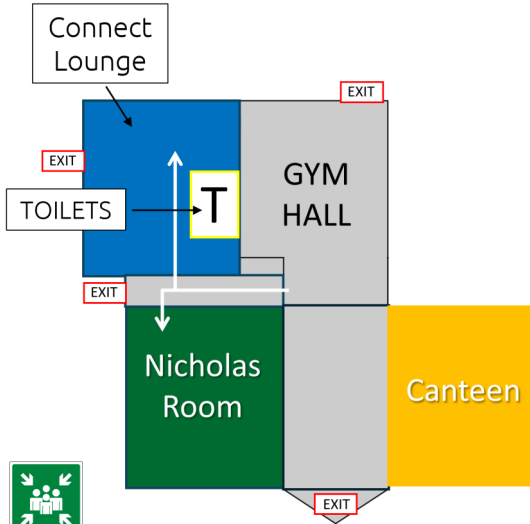

Church Office

Ph. 3834895. 52 Bassett St.
Christchurch 8083
Email: office@legacycommunity.nz

www.legacycommunity.nz

Contact Us

Church Staff

Lead Pastors: **Nigel & Mana Ripley**

Nigel: n.ripley@legacycommunity.nz

p: 027 2293184

Mana: mana.r@legacycommunity.nz

p: 027 3399322

Junior Church Pastor: **Amber Tucker**

e: amber.t@legacycommunity.nz

p: 027 4211421

Lead Youth Worker: **Jacinta Gomez**

e: jacinta.g@legacycommunity.nz

p: 0273348398

Community Worker: **Lara Cook**

e: community.worker@legacycommunity.nz

p: 0274938053

Kitchen Manager: **Rose Barker**

p: 0272573828

[Note: Staff are unavailable on Mondays as this is their day off]

Note Taking

3 things I need to do or give attention to:
