

Sunday 14 April 2024
NEWSLETTER

Haere mai - Welcome!

If you're new to Legacy, we pray you feel welcomed and refreshed. Please ask one of our host team if there's anything you would like to know or get help in.

Our service begins and ends with a hot drink as part of our 'welcome' and providing time to connect. Today is our Celebration Service, so we'll finish with a shared lunch. Please do stay on!

Legacy

Community
Church

*A community of worshipping disciples;
overflowing with God's love and presence;
serving and transforming lives, communities
and generations with the gospel of Jesus Christ.*

Pre Service Prayer 9.30am in North Room 1



This morning our children will remain in the service with us, and we will be finishing with a shared lunch. If you're visiting today, lunch has been prepared for you, so please do stay and join us!

This Week

Social Volleyball

Mondays 7 - 9pm, here in the gym; high powered but friendly. See Ps Nigel for more info'

Life Cells

These are where our church gathers in small groups for connection, prayer and encouragement. Tuesday and Wednesday nights 7:30pm. See a Pastor for details.

LiVE Community

There is no drop in centre during the school holidays this week or next, however there will be 2 coffee events happening, talk to Priscilla for more info'.

Pre-Work Prayer

This Friday 7.30am in the Tōtara Room.

SWAT Playgroup

There will be no SWAT during the school holidays

Legacy Youth Centre

This Friday 7-9pm in the Nicholas Room for high school aged youth.

A church letter has been emailed out this week, if you haven't yet seen it check your junk mail folder, or make sure to update your email info' with the office. If you're not on email, grab a physical copy from Ps. Nigel today.

Ladies Night Coming Up!

Saturday 4 May, 7pm
Save the Date!

A special time set aside in our calendar for our Ladies to connect, encourage, be encouraged and pray for one another!



Coming Up

This is a valuable time we set aside in our calendars to spend a weekend together as a church family. Reserve the weekend and save some money, and registration forms will be out in September.

Donations receipts will be issued at the end of April

Finances

Giving References:

Legacy Building Fund - 'LBF'

Vision & Grace Funds (for charity and mission) - 'VG'

Uganda School & Church - 'VGU'

'Tithes': Provides for the week to week running of the church and all we do.

Giving envelopes are by the 'Donations' box in the foyer on the info' table.

Remember to use your giving # if you would like a receipt for giving.

If you don't have a giving # contact the office and they will assign you one.

Further details re' online giving are in the giving envelope.

ACCOUNT NUMBER: **031700 0005835 000**

Receipts will be issued in April each year.

For more info, email: finance@legacycommunity.nz, or phone our office: 3834895



Audio versions of our Service Messages are available online via [legacycommunity.nz/resources](https://www.legacycommunity.nz/resources) or see our YouTube channel for older service videos.

www.legacycommunity.nz

Facility Map

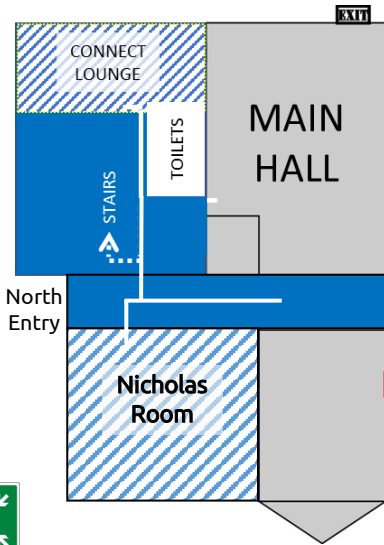

www.legacycommunity.nz

Contact Us

Church Office

Ph. 3834895. 52 Bassett St.

Christchurch 8083

Email: office@legacycommunity.nz

Or: finance@legacycommunity.nz

Specific Enquiries

Lead Pastors: **Nigel & Mana Ripley**

Nigel: n.ripley@legacycommunity.nz

p: 027 2293184

Mana: mana.r@legacycommunity.nz

p: 027 3399322

Junior Church Pastor: **Amber Tucker**

e: amber.t@legacycommunity.nz

p: 027 4211421

Lead Youth Worker: **Jacinta Gomez**

e: jacinta.g@legacycommunity.nz

p: 0273348398

Community Worker: **Priscilla Lowe**

e: priscilla.l@legacycommunity.nz

p: 3834895

[Note: Staff are unavailable on Mondays as this is their day off]

Note Taking

3 things I need to do or give attention to:
