

Sunday 11 February 2024

NEWSLETTER

Haere mai - Welcome!

If you're new to Legacy, we pray you feel welcomed and refreshed. Please ask one of our host team if there's anything you would like to know or get help in.

Our service begins and ends with a hot drink as part of our 'welcome' and providing time to connect. please do stay on so we can get to know you.

Speaking today: **Ps Nigel Ripley**

Legacy

**Community
Church**

*A community of worshipping disciples;
overflowing with God's love and presence;
serving and transforming lives, communities
and generations with the gospel of Jesus Christ.*

Pre Service Prayer 9.30am in North Room 1

Children's Programmes

Under 5's - Connect Lounge

Yr 0-5 'Oasis'- Nicholas Room, Yr 6-8 'Elevate' - also in the Nicolas Room

Start times will be announced during the service

NOTE: For health & safety reasons, visitors with children are asked to fill out a Children's programme 'Visitor's Form' and leave it with a leader in the programme. Thanks!

This Week

Social Volleyball

Mondays 7 - 9pm, here in the gym; high powered but friendly. See Ps Nigel for more info'

Prayer and Worship Special

This Tuesday night instead of Wednesday night, we'll be joining in with the Open Heaven combined churches Prayer event.

LIVE Community

Tuesday, Wednesday, Thursday 10am-12:30pm in the Nicholas Room!

Pre-Work Prayer

This Friday 7.30am in the Tōtara Room.

SWAT Playgroup

For pre-schoolers and their caregivers, Fridays 10:30am-12pm.
See Ps Mana for details.

Legacy Youth Centre

This Friday 7-9pm in the Nicholas Room for high school aged youth. See Jacinta for more info'.

Open Heaven - Combined Churches Prayer Event

THIS Tuesday 13 February 7pm
Christchurch Town Hall

Let's join with churches around NZ to pray for our nation. Tickets to be booked via event website:
openheaven.nz/christchurch
Some tickets are available with Ps Nigel.



⁹ After this I looked, and behold, a great multitude that no one could number, from every nation, from all tribes and peoples and languages, standing before the throne and before the Lamb, clothed in white robes, with palm branches in their hands, ¹⁰ and crying out with a loud voice, "Salvation belongs to our God who sits on the throne, and to the Lamb!"
Revelation 7:9-10

Giving References:

Legacy Building Fund - 'LBF'

Vision & Grace Funds (for charity and mission) - 'VG'

Uganda School & Church - 'VGU'

'Tithes': Provides for the week to week running of the church and all we do.

Giving envelopes are by the 'Donations' box in the foyer on the info' table.

Remember to use your giving # if you would like a receipt for giving.

If you don't have a giving # contact the office and they will assign you one.

Further details re' online giving are in the giving envelope.

ACCOUNT NUMBER: **031700 0005835 000**

Receipts will be issued in April each year.

For more info, email: finance@legacycommunity.nz, or phone our office: 3834895

Finances



Audio versions of our Service Messages are available online via legacycommunity.nz/resources or see our YouTube channel for older service videos.

www.legacycommunity.nz

Facility Map

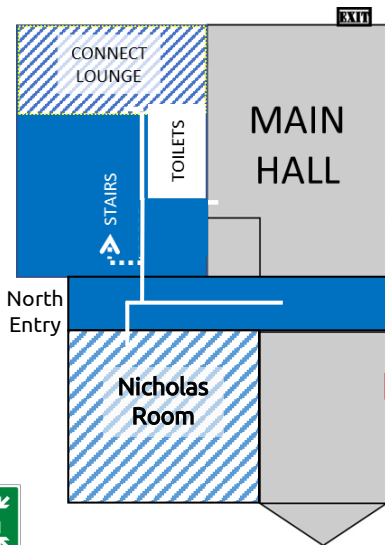

www.legacycommunity.nz

Contact Us

Church Office

Ph. 3834895. 52 Bassett St.

Christchurch 8083

Email: office@legacycommunity.nz

Or: finance@legacycommunity.nz

Specific Enquiries

Lead Pastors: **Nigel & Mana Ripley**

Nigel: n.ripley@legacycommunity.nz

p: 027 2293184

Mana: mana.r@legacycommunity.nz

p: 027 3399322

Junior Church Pastor: **Amber Tucker**

e: amber.t@legacycommunity.nz

p: 027 4211421

Lead Youth Worker: **Jacinta Gomez**

e: jacinta.g@legacycommunity.nz

p: 0273348398

Community Worker: **Priscilla Lowe**

e: priscilla.l@legacycommunity.nz

p: 3834895

[Note: Staff are unavailable on Mondays as this is their day off]

Note Taking

3 things I need to do or give attention to:
