

# Sunday 21 July 2024

## NEWSLETTER

Haere mai - Welcome!

If you're new to Legacy, we pray you feel welcomed and refreshed. Please ask one of our host team if there's anything you would like to know or get help in.

Our service begins and ends with a hot drink as part of our 'welcome' and providing time to connect. Please do stay on so we can get to know you.

Speaking today: **Ps Nigel Ripley**

# Legacy

**Community  
Church**

*A community of worshipping disciples;  
overflowing with God's love and presence;  
serving and transforming lives, communities  
and generations with the gospel of Jesus Christ.*

**Pre Service Prayer 9.30am in North Room 1**

## **Children's Programmes**

Under 5's - Connect Lounge

Yr 0-5 'Oasis'- Nicholas Room, Yr 6-8 'Elevate' - begin in the Nicolas Room.

Start times will be announced during the service

*NOTE: For health & safety reasons, visitors with children are asked to fill out a Children's programme 'Visitor's Form' and leave it with a leader in the programme. Thanks!*

## **This Week**

### **Social Volleyball**

Mondays 7 - 9pm, here in the gym; high powered but friendly. See

Ps Nigel for more info'

### **Prayer & Worship**

An important time of tuning out other things to tune our spirit into God's Spirit. Come and seek God, and unite in prayer for our church, community, and generations. Wednesday 7:30pm in the Tōtara Room.

### **LiVE Community**

Tuesday, Wednesday, Thursday 10am-12:30pm in the Nicholas Room!

### **Pre-Work Prayer**

This Friday 7.30am in the Tōtara Room.

### **SWAT Playgroup**

Fridays 10:30am-12pm. See Ps Mana for details.

### **Legacy Youth Centre**

This Friday 7-9pm in the Nicholas Room for high school aged youth.

## **Coming Up**

### **Ministry Leaders Meeting**

Wednesday 31 July, 7.30pm will be a Ministry Leaders' meeting. Life Cells will follow on the week after: 6-7 August.

### **Church Camp**

1-3 November; put aside this weekend for our time together



**Confusion to Clarity**  
Fri' 16 Aug' 7.30pm -  
Sat' 17 Aug' all day

This conference is focused on training Christians in apologetics, Christian worldview and evangelism. For info' on the speakers and topics, and to register visit their website:  
[conference.thinkingmatters.org.nz](http://conference.thinkingmatters.org.nz)



### COMMUNITY WHANAU FOOD FUN

Would you like to be on a team to help run a games night or 'fellowship' night once a month? Contact Ps Nigel for info.

[n.ripley@legacycommunity.nz](mailto:n.ripley@legacycommunity.nz)

We'll be looking to start a Foundation Stage 1 Bible study soon, if you'd like to join in, or have any questions see Ps Nigel.



If you haven't yet been baptised, there will be a Baptism service coming up later this year. Contact Ps Nigel to get further information if you haven't been baptised yet.



### Giving References:

Legacy Building Fund - 'LBF'

Vision & Grace Funds (for charity and mission) - 'VG'

Uganda School & Church - 'VGU'

**'Tithes':** Provides for the week to week running of the church and all we do.

Giving envelopes are by the 'Donations' box at the back on the info' table.

Remember to use your giving # if you would like a receipt for giving.

If you don't have a giving # contact the office and they will assign you one.

Further details re' online giving are in the giving envelope.

ACCOUNT NUMBER: **031700 0005835 000**

Receipts will be issued in April each year.

For more info, email: [finance@legacycommunity.nz](mailto:finance@legacycommunity.nz), or phone our office: 3834895

## Finances



Audio versions of our Service Messages are available online via [legacycommunity.nz/resources](http://legacycommunity.nz/resources) or see our YouTube channel for older service videos.

[www.legacycommunity.nz](http://www.legacycommunity.nz)

# Facility Map

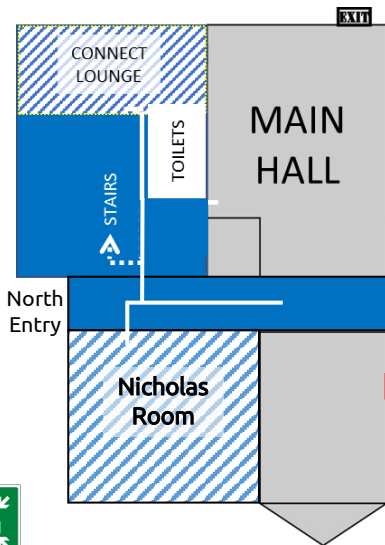

[www.legacycommunity.nz](http://www.legacycommunity.nz)

# Contact Us

## Church Office

Ph. 3834895. 52 Bassett St.

Christchurch 8083

Email: [office@legacycommunity.nz](mailto:office@legacycommunity.nz)

Or: [finance@legacycommunity.nz](mailto:finance@legacycommunity.nz)

## Specific Enquiries

Lead Pastors: **Nigel & Mana Ripley**

Nigel: [n.ripley@legacycommunity.nz](mailto:n.ripley@legacycommunity.nz)

p: 027 2293184

Mana: [mana.r@legacycommunity.nz](mailto:mana.r@legacycommunity.nz)

p: 027 3399322

Junior Church Pastor: **Amber Tucker**

e: [amber.t@legacycommunity.nz](mailto:amber.t@legacycommunity.nz)

p: 027 4211421

Lead Youth Worker: **Jacinta Gomez**

e: [jacinta.g@legacycommunity.nz](mailto:jacinta.g@legacycommunity.nz)

p: 0273348398

Community Worker: **Lara Cook**

e: [community.worker@legacycommunity.nz](mailto:community.worker@legacycommunity.nz)

p: 3834895

[Note: Staff are unavailable on Mondays as this is their day off]

# Note Taking

*3 things I need to do or give attention to:*

---

---

---