

# Sunday 18 February 2024

## NEWSLETTER

Haere mai - Welcome!

If you're new to Legacy, we pray you feel welcomed and refreshed. Please ask one of our host team if there's anything you would like to know or get help in.

Our service begins and ends with a hot drink as part of our 'welcome' and providing time to connect. please do stay on so we can get to know you.

Speaking today: **Ps Nigel Ripley**

# Legacy

**Community  
Church**

*A community of worshipping disciples;  
overflowing with God's love and presence;  
serving and transforming lives, communities  
and generations with the gospel of Jesus Christ.*

Pre Service Prayer 9.30am in North Room 1

## Children's Programmes

Under 5's - Connect Lounge

Yr 0-5 'Oasis'- Nicholas Room, Yr 6-8 'Elevate' - also in the Nicholas Room

Start times will be announced during the service

*NOTE: For health & safety reasons, visitors with children are asked to fill out a Children's programme 'Visitor's Form' and leave it with a leader in the programme. Thanks!*

## This Week

### Social Volleyball

Mondays 7 - 9pm, here in the gym; high powered but friendly. See Ps Nigel for more info'

### Life Cells

These are where our church gathers in small groups for connection, prayer and encouragement. Tuesday and Wednesday nights 7:30pm.

See a Pastor for details.

### LiVE Community

Tuesday, Wednesday, Thursday 10am-12:30pm in the Nicholas Room!

### Pre-Work Prayer

This Friday 7.30am in the Tōtara Room.

### SWAT Playgroup

For pre-schoolers and their caregivers, Fridays 10:30am-12pm.

See Ps Mana for details.

### Legacy Youth Centre

This Friday 7-9pm in the Nicholas Room for high school aged youth. See Jacinta for more info'.

## Coming Up

### Soul Mates

A marriage booster for couples at Legacy, 12 March 7pm.

### A Night of Power

A powerful testimony of Dr Ahmed Joktan, here at Legacy 24 March 7pm.

## Special Ministry Highlight– Legacy Life Cells



At Legacy, our small groups are called 'Life Cells' and are places for you to connect, encourage, pray, and belong. Groups are limited to 12 people so it's easier to share and include everyone. Something unique about our groups, are that they are multi-generational. We believe God has deposited something special and unique into each generation, that we all need to benefit from. This is a beautiful way of growing a culture of community, support, and belonging. Ages 17+. There is always room for you - contact Ps Mana to be part of one.

*Praise the LORD, all you nations.  
Praise him, all you people of the earth.  
For his unfailing love for us is powerful;  
the LORD's faithfulness endures forever.  
Praise the LORD.  
Psalm 117*



Remember to stock up on RAT tests from your pharmacy so you're ready to test to reduce spreading CoVID around our community. Free tests available from Burwood Pharmacy on Parnwell street.

### Giving References:

Legacy Building Fund - 'LBF'

Vision & Grace Funds (for charity and mission) - 'VG'

Uganda School & Church - 'VGU'

**'Tithes':** Provides for the week to week running of the church and all we do.

Giving envelopes are by the 'Donations' box in the foyer on the info' table.

Remember to use your giving # if you would like a receipt for giving.

If you don't have a giving # contact the office and they will assign you one.

Further details re' online giving are in the giving envelope.

ACCOUNT NUMBER: **031700 0005835 000**

Receipts will be issued in April each year.

For more info, email: [finance@legacycommunity.nz](mailto:finance@legacycommunity.nz), or phone our office: 3834895

## Finances



Audio versions of our Service Messages are available online via [legacycommunity.nz/resources](https://www.legacycommunity.nz/resources) or see our YouTube channel for older service videos.

# Facility Map

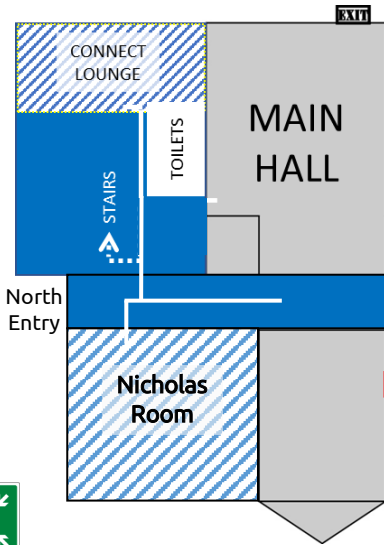

[www.legacycommunity.nz](http://www.legacycommunity.nz)

# Contact Us

## Church Office

Ph. 3834895. 52 Bassett St.

Christchurch 8083

Email: [office@legacycommunity.nz](mailto:office@legacycommunity.nz)

Or: [finance@legacycommunity.nz](mailto:finance@legacycommunity.nz)

## Specific Enquiries

Lead Pastors: **Nigel & Mana Ripley**

Nigel: [n.ripley@legacycommunity.nz](mailto:n.ripley@legacycommunity.nz)

p: 027 2293184

Mana: [mana.r@legacycommunity.nz](mailto:mana.r@legacycommunity.nz)

p: 027 3399322

Junior Church Pastor: **Amber Tucker**

e: [amber.t@legacycommunity.nz](mailto:amber.t@legacycommunity.nz)

p: 027 4211421

Lead Youth Worker: **Jacinta Gomez**

e: [jacinta.g@legacycommunity.nz](mailto:jacinta.g@legacycommunity.nz)

p: 0273348398

Community Worker: **Priscilla Lowe**

e: [priscilla.l@legacycommunity.nz](mailto:priscilla.l@legacycommunity.nz)

p: 3834895

[Note: Staff are unavailable on Mondays as this is their day off]

# Note Taking

*3 things I need to do or give attention to:*

---

---

---